

Ceiling Plate

Thank you for buying a CEILING PLATE. In circumstances where your X-POLE set is being installed at heights between 2750mm and 3370mm it is recommended to use a Ceiling plate – between 3370mm and 3500mm it becomes mandatory. This only applies to the use of pole in the home. For studio installation requirements, please refer to our Studio Guide.

This is a 368mm (14.5") diameter plate cut from 8mm (0.4") plywood/MDF which is screwed to the ceiling into the joists. The upper dome of your XPERT set then fits over the top of the plate and should the pole loosen, the plate will prevent the upper dome from moving or slipping.

CRITICAL INFORMATION

To get the best from your CEILING PLATE – with SAFETY being the utmost priority – it is extremely important that you READ & FOLLOW the Instruction Manual from beginning to end and most importantly, understand it!

BEFORE USING YOUR POLE

Mis-using a pole can be dangerous, not only to the user but also to anyone close to the pole. The use of a dance pole is always at the user's discretion, and it is the user's responsibility to check the pole is installed correctly & safely before use. Follow the simple but explicit instructions in this manual to get the best results from your pole set. Safety is a priority at all times.

If you have ANY questions – before you assemble, install or use your CEILING PLATE – contact your point of purchase or see the support section on the website (www.xpole.com – first select your region, then search for the support section).

CAUTION: The CEILING PLATE SHOULD NOT be installed under false, suspended or non-rigid ceilings. When searching for Joists please use a step ladder and have a second person holding the ladder providing additional assistance.

WE RECOMMEND THAT THE INSTALLATION OF THE CEILING PLATE BE CARRIED OUT BY A PROFESSIONAL.

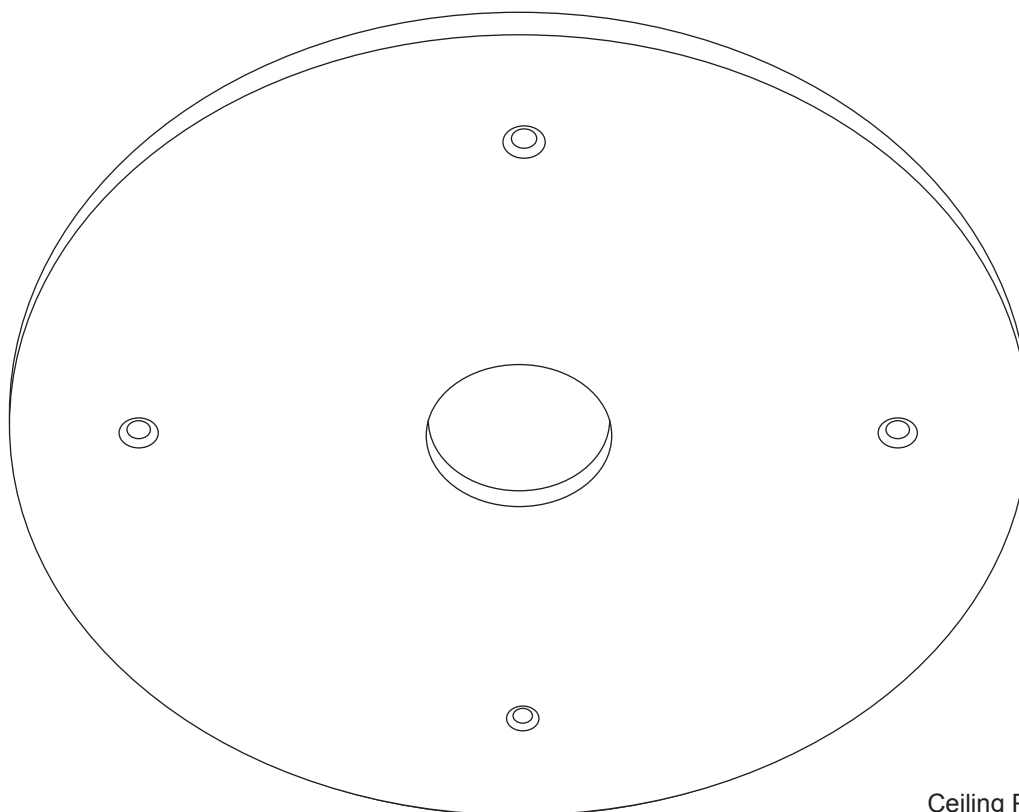

Ceiling Plate
XP050CR-0010PLT

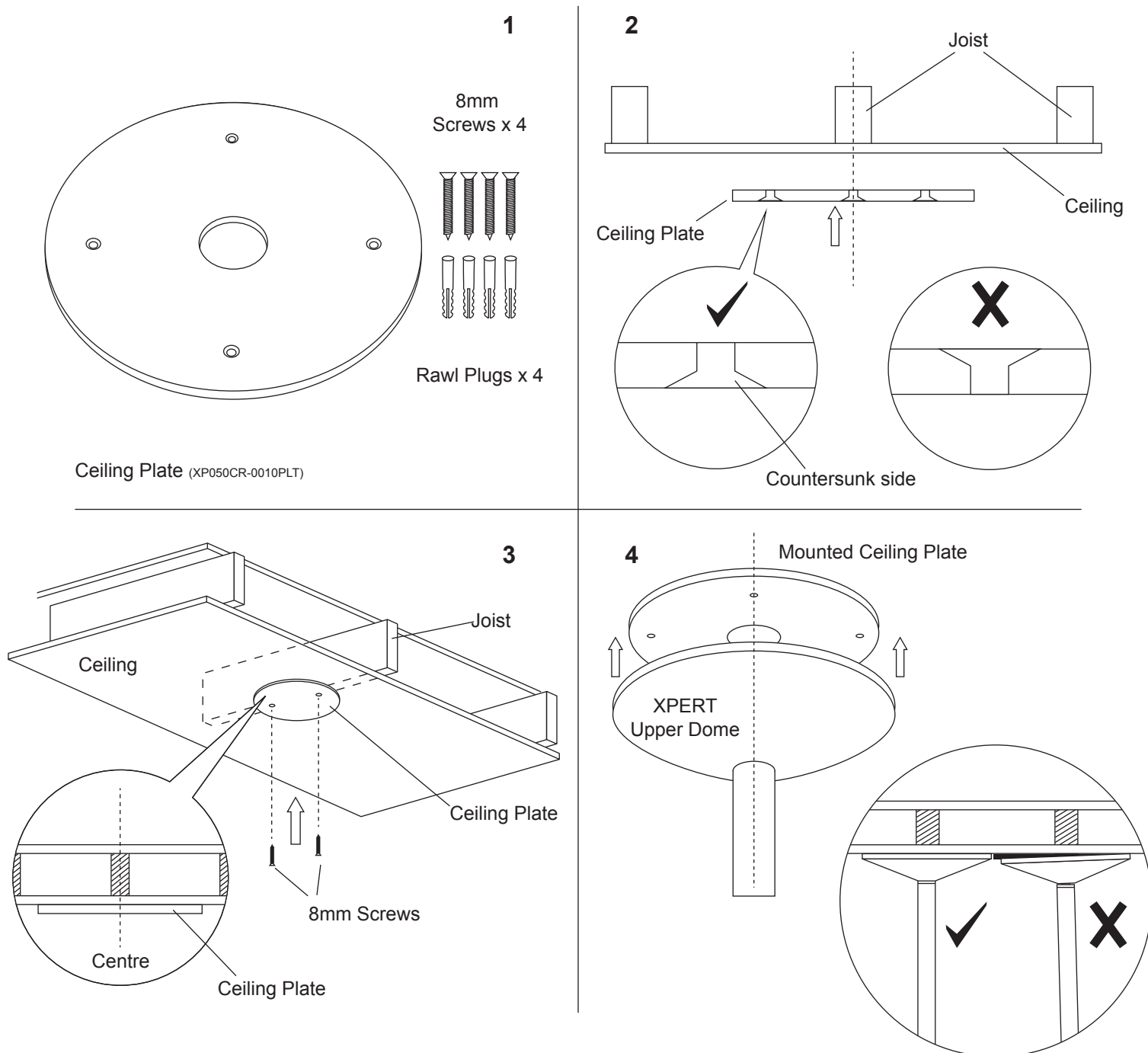

1. Included in the pack, is a 368mm (14.5") Ceiling plate, 4 x Rawl plugs (only for concrete ceilings – not required for wooden joists) & 4 x Screws for installation. When installing into a concrete ceiling, you will require a masonry drill (8mm/0.31" drill bit).
2. Locate the Ceiling Plate directly under a joist. The Ceiling Plate has 4 screw holes – please make sure the counter sunk side (CSK) is facing down. Please ensure that at least 2 of the screw holes are located in line with the joist and mark the area where the screws will be installed. Please refer to the diagram. It may be advisable to drill two pilot holes where the screws will be installed (you will require a 3.5mm/0.13" drill bit).
3. Whilst ensuring that the ceiling plate screw holes are in line with the centre of the joist, install only two screws, so that when the screws are tightened, they are tightened into the joist.
4. Once the ceiling plate is completely installed, the Upper Dome of your XPERT pole set can now be located directly under the Ceiling Plate. Please continue to follow your instructions from your XPERT pole set to finish installation of your pole.

In instances where the ceiling joists are located close to one another, all 4 screws, if viable, could be fastened, on the basis, that they all enter a solid joist.